

# User Manual

## NUX Drum System **DM-110** DIGITAL DRUM KIT





**NUX**  
Cherub Technology Co., Ltd.  
[www.nuxaudio.com](http://www.nuxaudio.com)

USING THE UNIT SAFELY

INSTRUCTIONS FOR THE PREVENTION OF FIRE, ELECTRIC SHOCK, OR INJURY TO PERSONS

About ⚠️ WARNING and ⚠️ CAUTION Notices About the Symbol

 <b>WARNING</b>	Used for instructions intended to alert the user to the risk of death or severe injury should the unit be used Improperly.
 <b>CAUTION</b>	Used for instructions intended to alert the user to the risk of injury or material damage should the unit be used improperly. * Material damage refers to damage or other adverse effects caused with respect to the home and all its furnishings, as well to domestic animals or pets.

ALWAYS OBSERVE THE FOLLOWING

⚠️ WARNING

- Before using this unit, make sure to read the instructions below and the Owner’s Manual.
- Do not open (or modify in any way) the unit or its AC adaptor.
- Do not attempt to repair the unit, or replace parts within it (except when this manual provides specific instructions directing you to do so). Refer all servicing to your retailer, the nearest NUX Service Center.
- Never use or store the unit in places that are:
  - Subject to temperature extremes (e.g., direct sunlight in an enclosed vehicle, near a heating duct, on top of heat-generating equipment); or are
  - Damp (e.g., baths, washrooms, on wet floors); or Are
  - Humid; or Are
  - Exposed to rain; or Are
  - Dusty; or Are
  - Subject to high levels of vibration.
- This unit may be installed on a stand using a Clamp.
- When installing the unit on a stand with a clamp, the stand must not be placed in an unstable location or on an incline, but in a level and stable position. Even if a stand is not used,make sure that the unit is placed in a stable location.

⚠️ WARNING

- Be sure to use only the AC adaptor supplied with the unit. Also, make sure the line voltage at the installation matches the input voltage specified on the AC adaptor’s body. Other AC adaptors may use a different polarity, or be designed for a different voltage, so their use could result in damage, malfunction, or electric shock.
- Do not excessively twist or bend the power cord, nor place heavy objects on it. Doing so can damage the cord, producing severed elements and short circuits. Damaged cords are fire and shock Hazards!
- This unit, either alone or in combination with an amplifier and headphones or speakers, may be capable of producing sound levels that could cause permanent hearing loss. Do not operate for a long period of time at a high volume level, or at a level that is uncomfortable. If you experience any hearing loss or ringing in the ears, you should immediately stop using the unit, and consult an Audiologist.
- Do not allow any objects (e.g., flammable material,coins, pins); or liquids of any kind (water, soft drinks,etc.) to penetrate the unit.

⚠️ WARNING

- Immediately turn the power off, remove the AC adaptor from the outlet, and request servicing by your retailer, the nearest NUX Service Center.
- The AC adaptor or the power-supply cord has been damaged; or
- If smoke or an unusual odor occurs
- Objects have fallen into, or liquid has been spilled onto the unit; or
- The unit has been exposed to rain (or otherwise has become wet); or
- The unit does not appear to operate normally or exhibits a marked change in performance.

- In households with small children, an adult should provide supervision until the child is capable of following all the rules essential for the safe operation of the unit.

- Protect the unit from strong impact. (Do not drop it!)

- Do not force the unit’s power-supply cord to share an outlet with an unreasonable number of other devices. Be especially careful when using extension cords—the total power used by all devices you have connected to the extension cord’s outlet must never exceed the power rating (watts/amperes) for the extension cord. Excessive loads can cause the insulation on the cord to heat up and eventually melt through.

- Before using the unit in a foreign country, consult with your retailer, the nearest NUX Service Center.

⚠️ CAUTION

- The unit and the AC adaptor should be located so their location or position does not interfere with their proper ventilation.

- Always grasp only the output plug or the body of the AC adaptor when plugging into, or unplugging from, this unit or an outlet.

- Any accumulation of dust between the AC adaptor and the power outlet can result in poor insulation and lead to fire. Periodically wipe away such dust with a dry cloth. Also, disconnect the power plug from the power outlet whenever the unit is to remain unused for an extended period of time.

- Try to prevent cords and cables from becoming entangled. Also, all cords and cables should be placed so they are out of the reach of children.

- Never climb on top of, nor place heavy objects on the unit.

- Never handle the AC adaptor body, or its output plugs, with wet hands when plugging into, or unplugging from, an outlet or this unit.

- If you need to move the instrument, take note of the precautions listed below. Make sure to have a firm grip, to protect yourself from injury and the instrument from damage.
  - Check to make sure that the clamp that fixes the unit to the stand has not become loose. Fasten them again securely whenever you notice any loosening.
  - Disconnect the power cord.
  - Disconnect all cords coming from external devices.

- Before cleaning the unit, turn off the power and unplug the AC adaptor from the outlet.

- Whenever you suspect the possibility of lightning in your area, disconnect the AC adaptor from the outlet.

- Should you remove security screws, make sure to put them in a safe place out of children's reach, so there is no chance of them being swallowed accidentally.

CONTENTS

Quick Installation Guide .....	04
Drum Parts .....	07
Control Panel .....	08
Audio Connection .....	09
Ready to Play .....	10
Operation .....	13
Drum Kit Operation .....	13
APP .....	13
TRRS Record .....	13
Reset .....	13
MIDI List .....	13
Specification .....	14

QUICK INSTALLATION GUIDE

Installation

1. Please connect all the mounting components and holders to secure the bracket firmly.

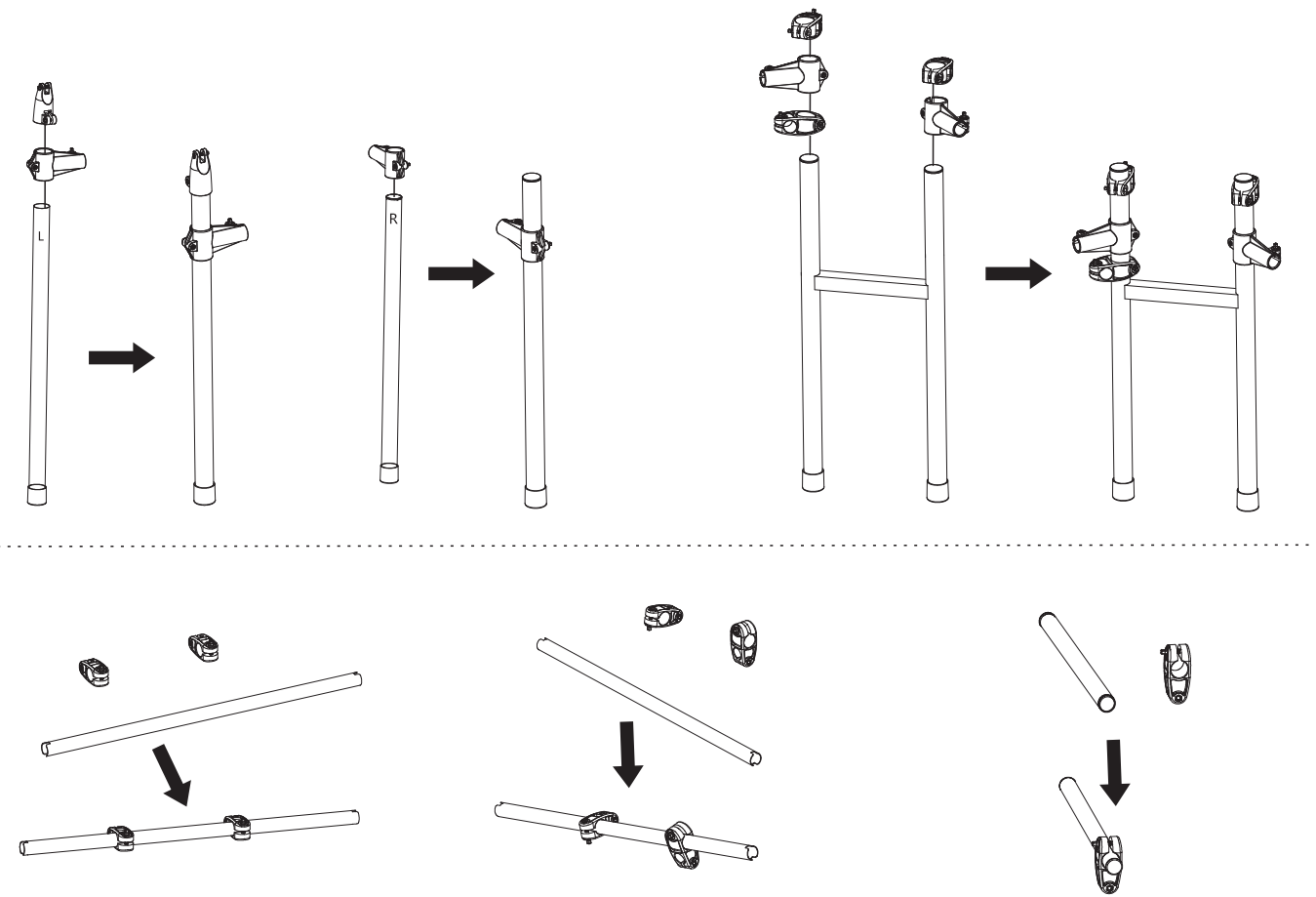

2. Please secure the cymbal nut, felt washer, and cymbal mount to the cymbal.

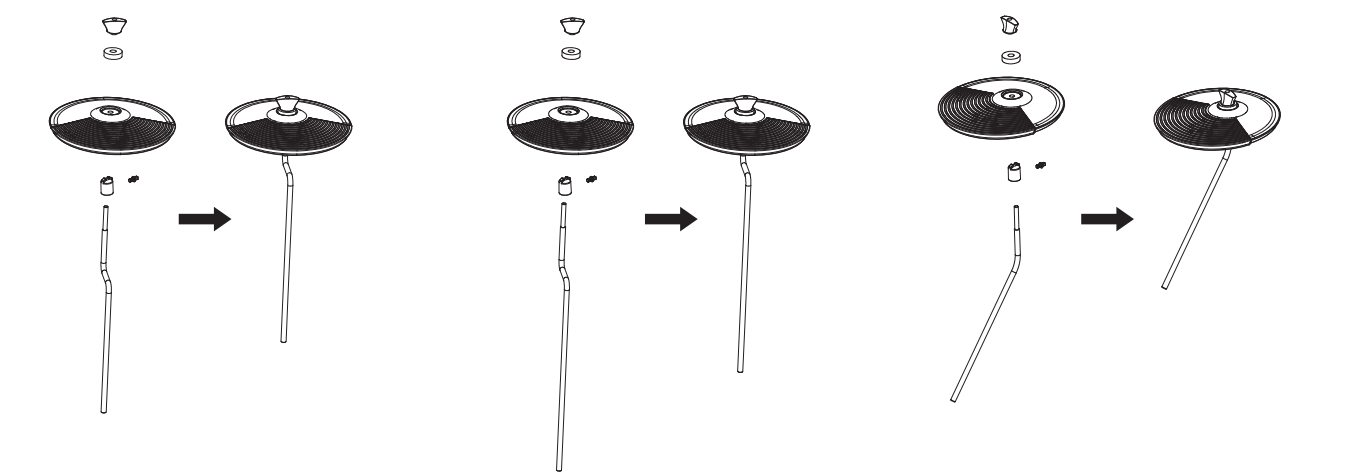

QUICK INSTALLATION GUIDE

Diagram

3. Install the drum rack.

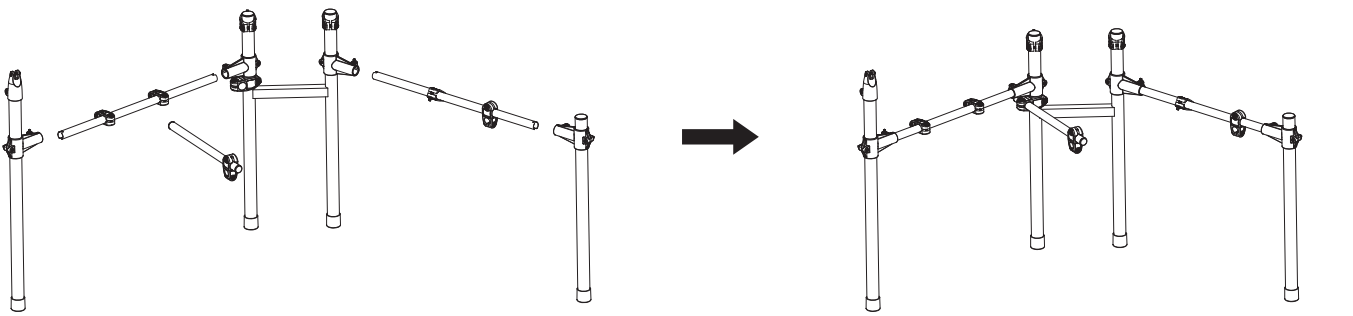

4. Install the drum pads and sound module.

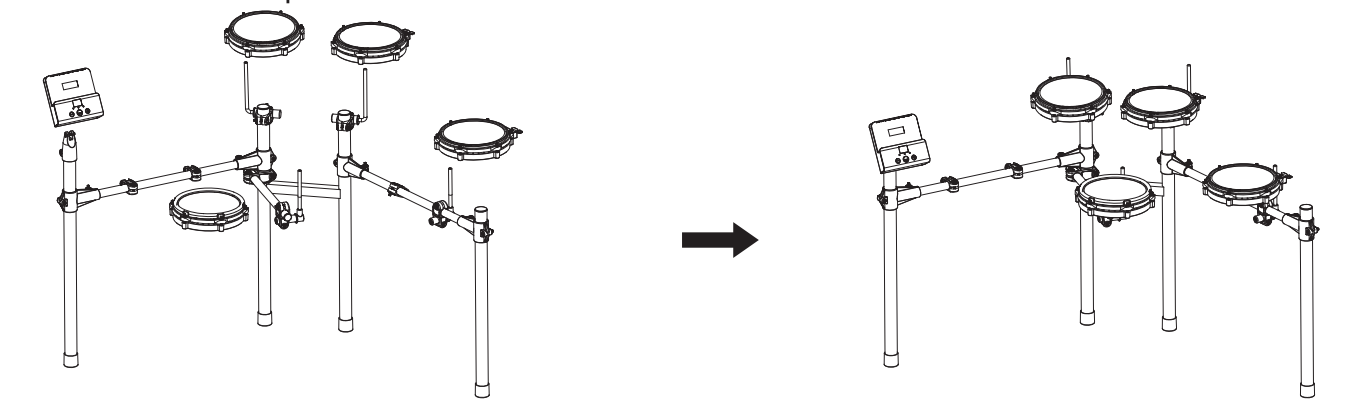

5. Install the drum cymbals.

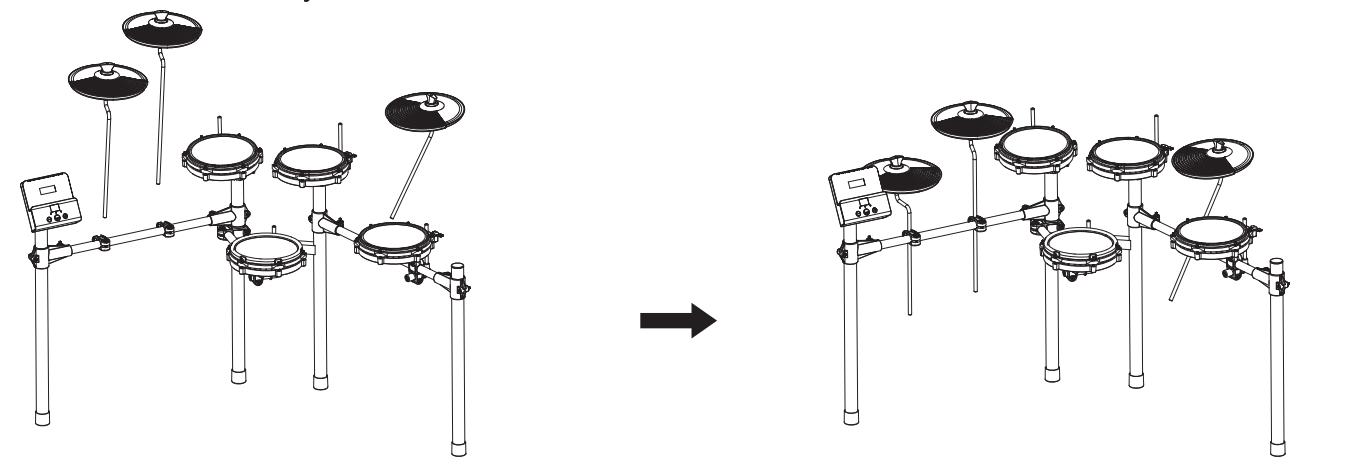

6. Install the hi-hat pedal, kick and kick pedal.

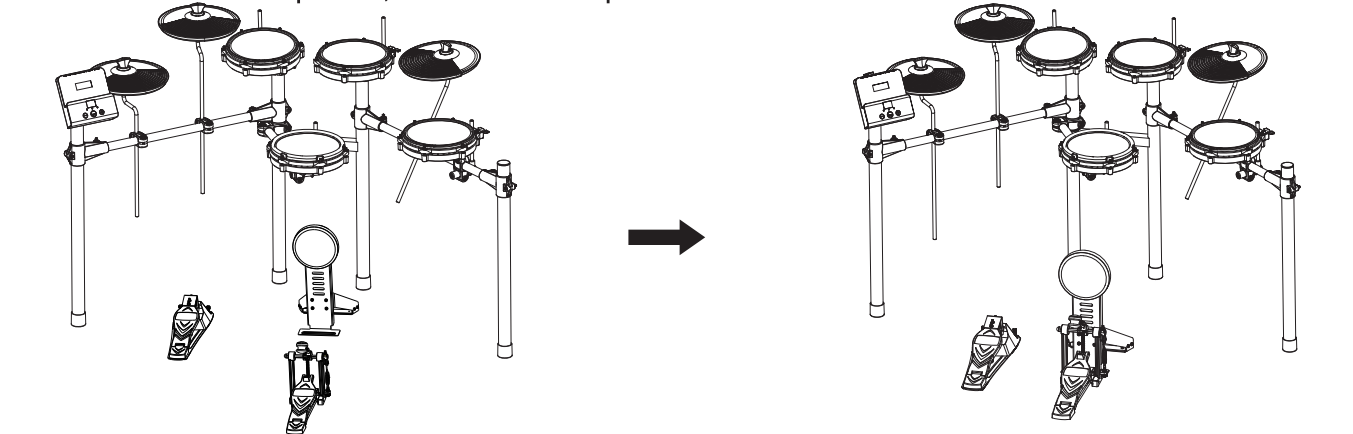

QUICK INSTALLATION GUIDE

Drum Connection

1. Connect the cable to sound module as shown in the illustration. Insert the connector all the way, then turn the knobs to fasten it securely.

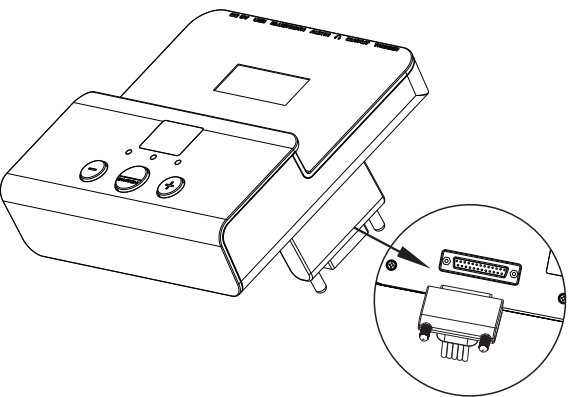

2. Lables indicating the pad to be connected are attached to the cables. Connect the cable to the output jack of each pad as shown in the illustration.

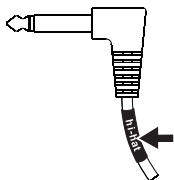

Connect the drum pad:

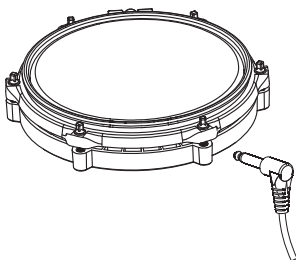

Connect the cymbal pad:

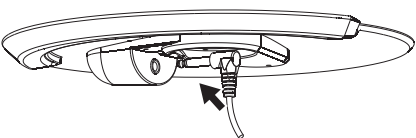

3. Connect the hh ctrl and kick.

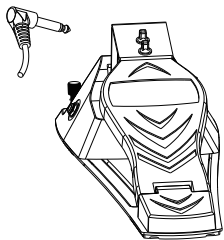

**Notes:** To prevent malfunction and equipment failure, please always turn down the volume, and turn off all the units before making any connections.



DRUM PARTS

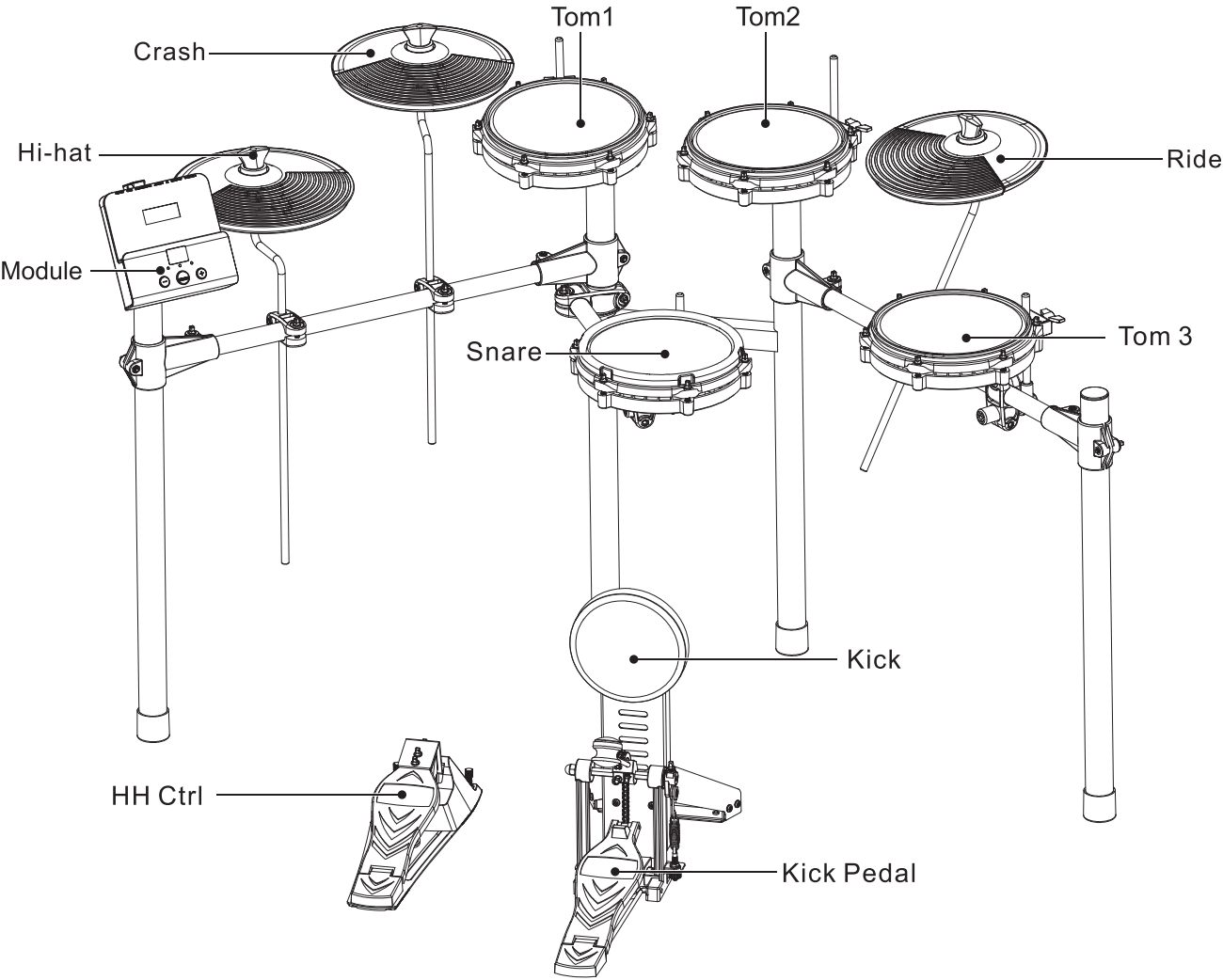

CONTROL PANEL



- 1. Display
- 2. Operation Button
- 3. Power/Switch Button
- 4. Operation Button

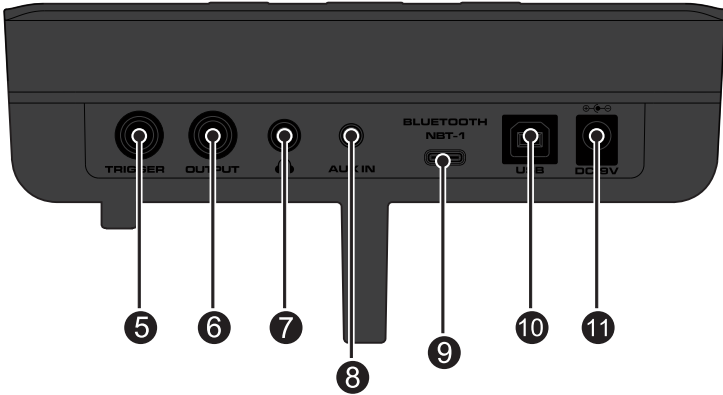

- |                       |                       |
|-----------------------|-----------------------|
| 5. Trigger Input      | 9. NUX BLUETOOTH      |
| 6. Output Jack (Mono) | Module NBT-1 Input    |
| 7. Headphone Output   | 10. USB-B             |
| 8. AUX Input          | 11. Power Input DC-9V |

AUDIO CONNECTION

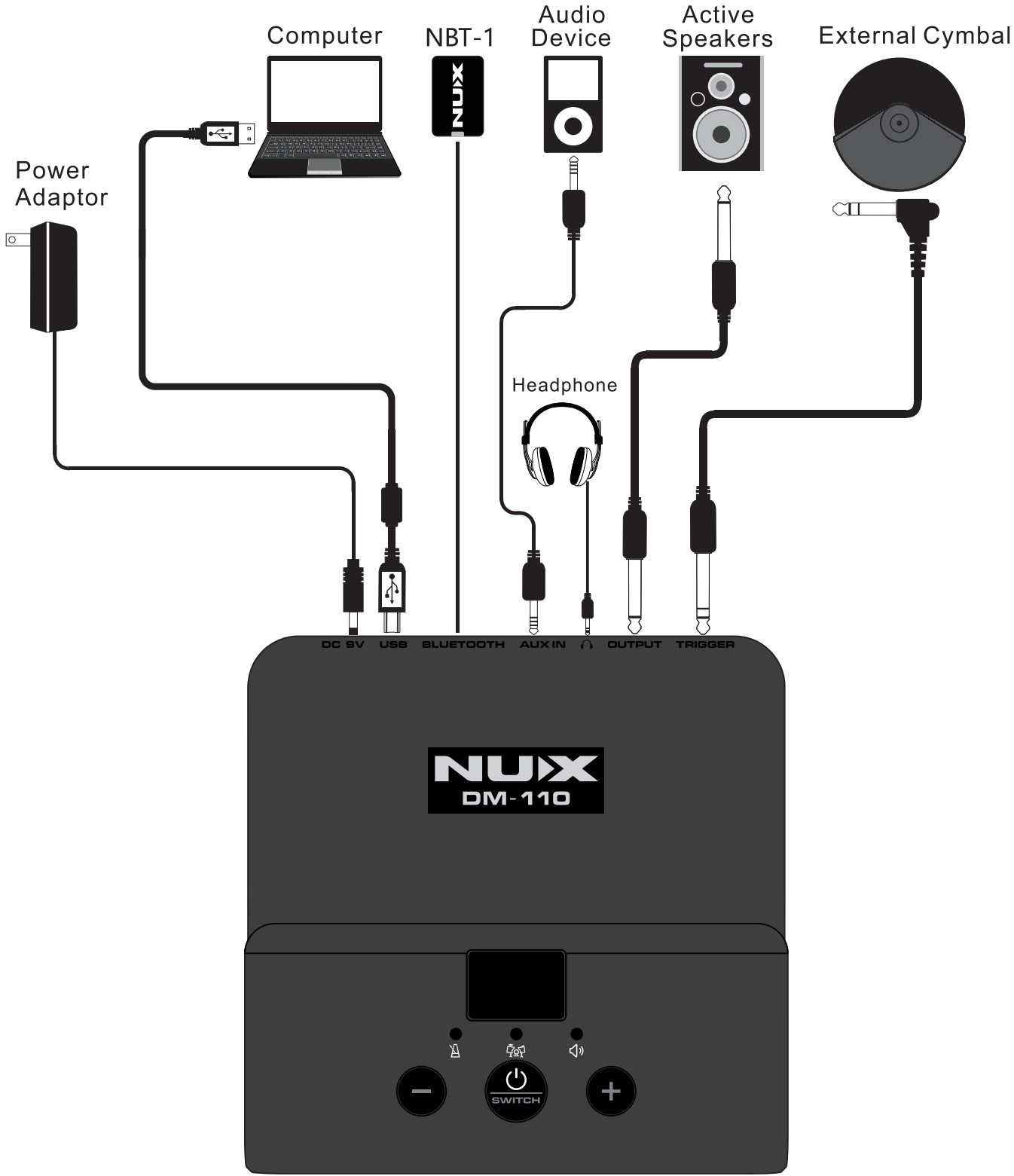

**Notes:** To prevent malfunction or damage to this device, please set the volume to minimum and turn off the power before starting up or connecting to other devices.

READY TO PLAY

\*Power ON

- 1. Please set the output device's output volume to the minimum level.
- 2. Turn on the power of DM-110.



**Notes:** When powering on, it is normal to hear a small noise from the connected speakers. This is a standard phenomenon during startup.

- 3. Adjust the volume to your preferred level by striking the drum pads and cymbals, or by increasing the output volume of the connected speakers.

\*Power OFF

- 1. Please set the output device's output volume to the minimum level.
- 2. Turn off the power of connected speakers.
- 3. Turn off the power of DM-110.



## READY TO PLAY

### \* Snare

#### Head shot

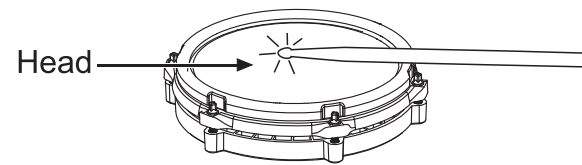

#### Rim shot

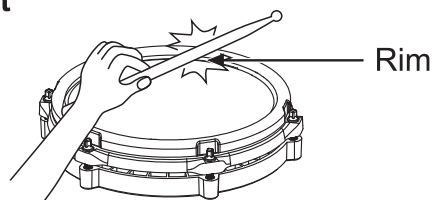

### \* Tom

#### Head shot

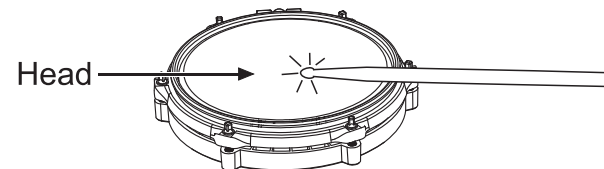

### \* Kick

#### Hit the drum head

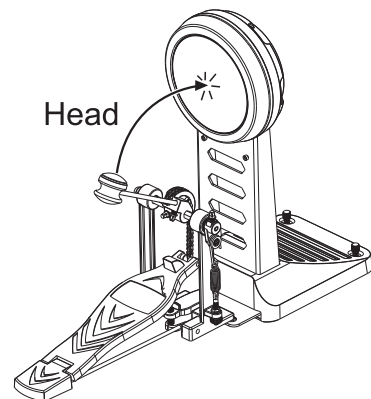

### \* Crash Ride

#### Bow shot

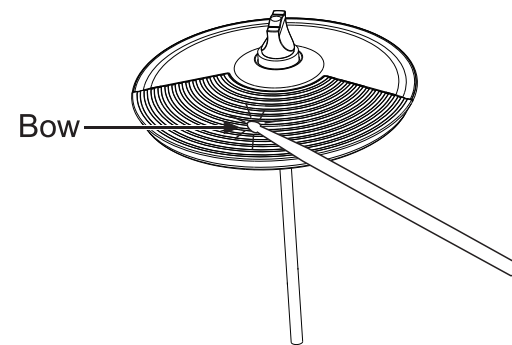

#### Edge shot

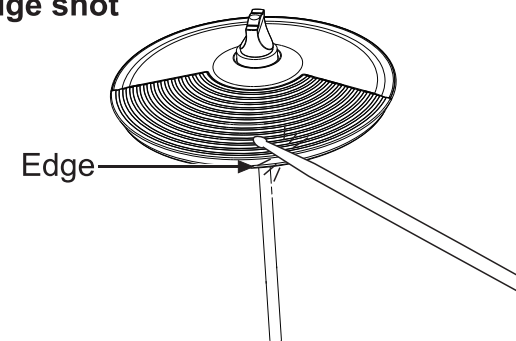

#### Choking a cymbal

Choking the cymbal's edge with your hand immediately after hitting it will effectively mute or choke the sound, similar to the technique used with real cymbals. This choking function is designed to work only when you grasp the cymbal in that specific area, allowing for realistic control over the sound produced.

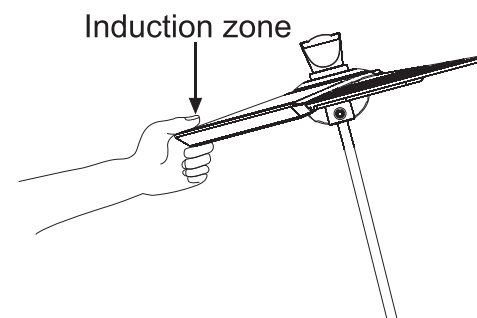

## READY TO PLAY

### \* Hi-hat

#### Open/Closed

The tone of the hi-hat varies between open and closed positions, influenced by the pressure applied to the hi-hat pedal and the interaction with the hi-hat blade.

#### Bow shot

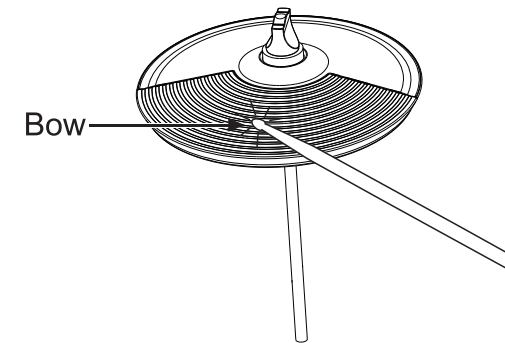

#### Choking a cymbal

Choking the cymbal's edge with your hand immediately after hitting it will effectively mute or choke the sound, similar to the technique used with real cymbals. This choking function is designed to work only when you grasp the cymbal in that specific area, allowing for realistic control over the sound produced.

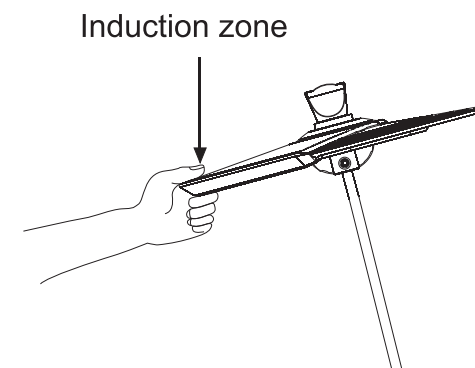

### \* HH Ctrl

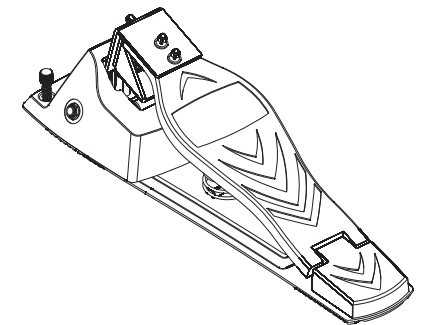

#### Open hi-hat

Strike the hi-hat without pressing the pedal.

#### Closed hi-hat

Strike the hi-hat with the pedal pressed.

OPERATION

\*Drum Kit Operation

Drum Kit

Press the Power/Switch button to activate the drum kit mode,indicated by the illuminated center light(as shown in the diagram). Press the “-” and “+” buttons to select different drum kit sounds.

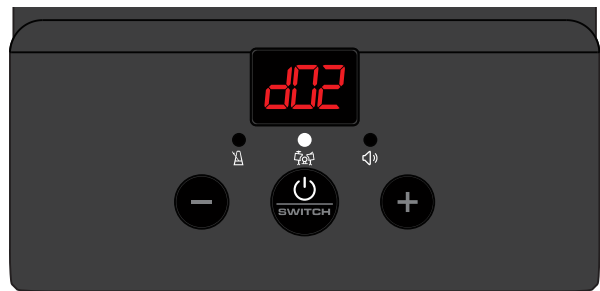

Metronome

Press the Power/Switch button to activate metronome mode,indicated by the left-side light(as shown in the diagram). Use the “-” and “+” buttons to adjust the metronome tempo.To turn off the metronome,press the Power/Switch button again.

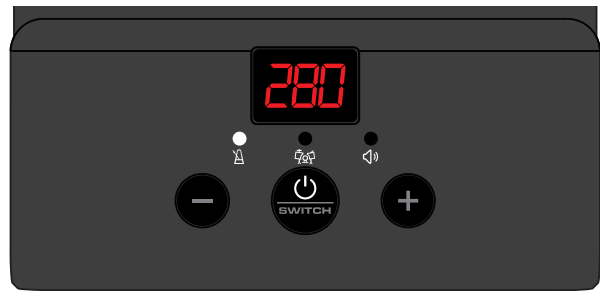

Output Volume

Press the Power/Switch button to activate volume mode,indicated by the right-side light (as shown in the diagram). Use the “-” and “+” buttons to adjust the output volume.

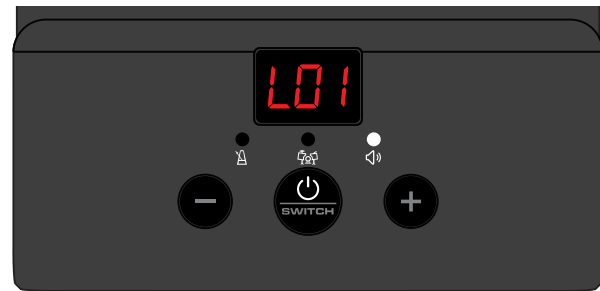

\*APP(Drum Touch)

After downloading and installing the app, connect your E-drum to your smartphone or pad, and you can control the E-drum through the app.



Scan the QR code to downlad the DM-110 app.

\*For comprehensive instructions on using Drum Touch and its features, please refer to the "Drum Touch User Guide" available on our official website - [www.nuxaudio.com](http://www.nuxaudio.com)

\*TRRS Record

- 1. Use a 1/8" TRRS cable to connect the AUX IN of the DM-110 to your mobile phone or iPad.
- 2. Open the recording app (such as the camera video) on your mobile phone or iPad. After pressing the record button, begin playing. The audio will be recorded onto your device.

\*Notes: Please use a 1/8" TRRS cable for TRRS record; otherwise, audio may not be recorded to your phone/iPad.

\*Reset

When powered off, press and hold both the “-” and “Power/Switch” buttons until the screen displays “FFF”. This will restore the DM-110 to its factory settings.

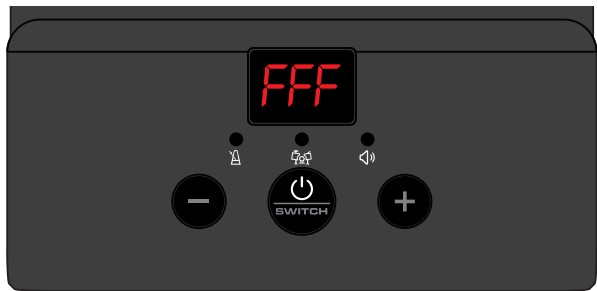

MIDI LIST

Function		Transmitted	Recognized	Remarked
Basic default		10	10	
Channel changed		Yes	Yes	
Note		0-127	0-127	
Velocity:	Note on	Yes	Yes	
	Note off	Yes	Yes	
After Key's		No	Yes	
Touch Channel's		No	Yes	
Control change:	0	No	Yes	Bank select
	1	No	Yes	Modulation
	5	No	Yes	Portamento time
	7	No	Yes	Volume
	10	No	Yes	Pan
	11	No	Yes	Expression
	64	No	Yes	Sustain pedal
	65	No	Yes	Portamento on/off
	66	No	Yes	Sostenuto pedal
	67	No	Yes	Soft pedal
	120	No	Yes	All sound off
	121	No	Yes	Reset all controllers
	123	No	Yes	All note off
Program change		No	Yes	
System exclusive		No	Yes	

SPECIFICATION

- Display: LED Segment Displays
- Drum kit: 12 presets, 3 user
- Effect: Master EQ,Reverb
- Pads: 8" Snare x 1, 8" Tom x 3, 10" Cymbalx3, Kick x 1,hi-hat pedal x 1
- USB: USB audio, USB MIDI
- Interface: USB, Trigger, BLUETOOTH module, Aux in, OUTPUT MONO, DC in, Phones
- Power: DC 9V external positive and internal negative,  
The working current is less than or equal to 200 mA

\*Technical specifications are subject to change without notice.

©Cherub Technology Co., Ltd.

All Rights Reserved. No part of this publication may be reproduced, stored in a retrieval system, or transmitted, in any form or by any means, electronic, mechanical, photocopying, recording, or otherwise, without the prior written permission of Cherub Technology Co., Ltd.



# 安全使用本乐器

为避免火灾、电击以及人身伤害，请遵循以下指示：

- 将本乐器的AC适配器插头与带有接地保护的电源插座连接。
- 请勿自行拆解或改动本乐器的任何部件，以免因操作不当而导致损坏。
- 请勿尝试自行修理或更换本乐器零件（除非说明书提供有安装选购配备的指示），如有任何关于本乐器的问题请就近咨询NUX服务中心或NUX授权经销商。
- 请勿将本乐器放置在以下场所：
  - 温度过高的场所（例如阳光直射下的封闭车辆中、热输送管附近或发热机器上方）。
  - 潮湿处（例如浴室、洗手间或潮湿的地面）。
  - 直接遭雨淋的地方。
  - 灰尘多的地方。
  - 有强烈震动的地方。
- 请将本乐器放置于平坦之处，以确保其稳固。请勿将本乐器放置于可能会摇晃的支架上或倾斜之处。
- 本乐器必须连接操作说明书中所指示的AC适配器，并且请勿将此AC适配器用于其它设备。
- 请勿过度扭曲或弯折AC适配器上的电源线，也不可以在此上面放置重物。这样可能会因损坏电源线而造成元件短路，重则可能造成火灾和触电的危险！
- 无论单独使用本乐器或者连接使用放大器、音箱或耳机时，过大的音量可能会导致听力永久损害。请勿长期在过大音量或者会导致不适的音量下使用。如果您感到任何听力损失或产生耳鸣，请停止使用并及时就诊。
- 请勿将任何物品（如易燃物、硬币、别针等）或任何液体，掉入或渗入本乐器中。
- 当发生以下情况时：
  - AC适配器、电源线或插头破损。
  - 任何部件冒烟或者发出异味。
  - 异物或液体不慎掉入或渗入本乐器。
  - 本乐器直接遭雨淋（或打湿）。
  - 本乐器音源主机显示异常（如出现乱码或黑屏等）。请立刻关闭音源主机电源，拔掉AC适配器插头，并与当地NUX服务中心或NUX授权经销商联系。
- 请注意家中的孩童。成人应监督孩童行为，直到他有能力遵循安全指示操作本乐器。
- 避免强烈的碰撞本乐器。（请勿摔落！）
- 请勿将过多的电器与本乐器共用一个插座。在使用延长电缆线时，请特别注意您连接在延长电缆线上的所有设备，其总功率绝不能超过延长电缆线所能承受的功率。电流的超载会导致电缆线发热并溶解包覆电缆线上的绝缘物质。
- 在国外使用本乐器之前，请与当地NUX服务中心或NUX授权经销商联系。
- 请勿将盛有水的容器（包括但不限于花瓶、杀虫剂、香水、酒精、指甲油或喷雾剂等）或饮料放置于本乐器上。擦拭本乐器时请使用柔软的干布。
- 请将本乐器放置在不影响其良好通风的场所或方向。
- 将AC适配器的插头插入或者拔离插座时，请手拿AC适配器的插头部分，并保证手部干爽。
- 每隔一段时间，您必须将AC适配器的插头从插座上拔掉，并用干布擦拭和清除累积在插

头上的灰尘。当长期不使用本乐器时，也请将AC适配器的插头拔离插座。在AC适配器的插头与插座之间沉积的灰尘可能会使绝缘不良从而导致火灾。

- 请避免各种线材之间互相缠绕（如AC适配器电源线、音频导线、其它外部连接线等）。此外，请让孩童远离所有线材，以免造成危险。
- 请勿踩踏或在本乐器上放置重物。
- 手部潮湿时，请勿使用本乐器（包括拔插电源设备）。
- 移动本乐器之前，请将AC适配器从音源主机上拔离，并且将与外部设备正连接的音频导线拔离音源主机。
- 清洁本乐器之前，请关闭音源主机电源，并将AC适配器插头从插座上拔离。
- 若怀疑您所在地区可能发生雷击时，请将AC适配器插头拔离插座。
- 请将螺丝等细小零部件放置于孩童触及不到的安全之处，以免孩童误吞食。



目录

组装示意图

04

各部件名称

07

音源控制面板

08

连接音频设备

09

准备演奏

10

功能操作

13

音源器面板操作

13

APP下载

13

AUX IN返录功能

13

恢复出厂设置

13

MIDI执行列表

14

技术规格

14

质量承诺

16

组装示意图

各部件组装

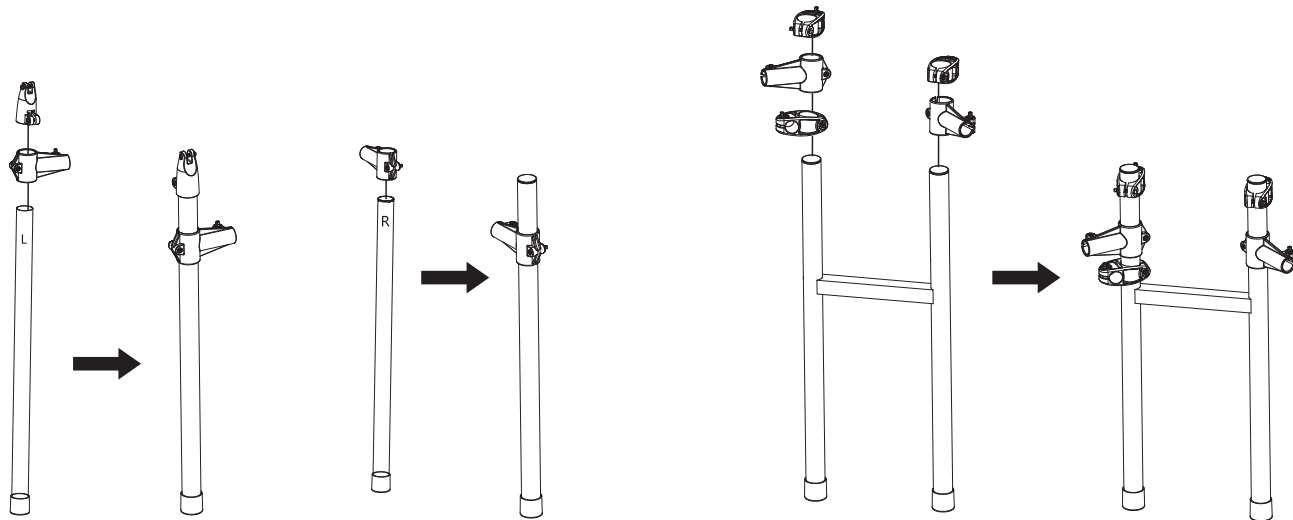

鼓架前左支架 (1PCS)      鼓架前右支架 (1PCS)      鼓架中间支架 (1PCS)

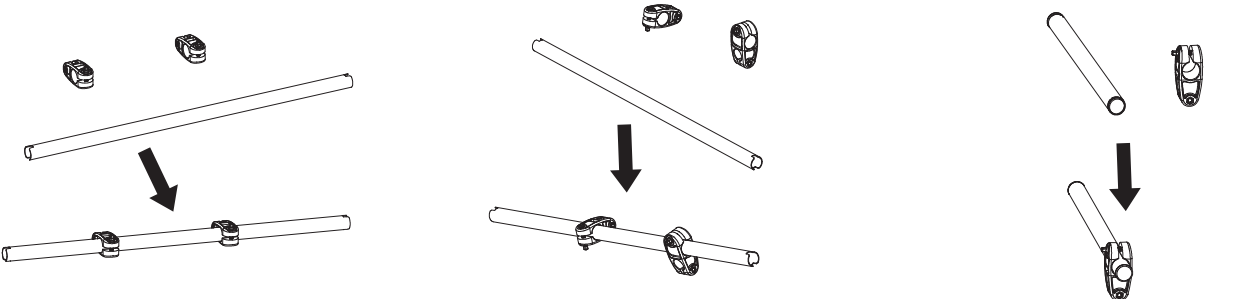

鼓架左侧臂 (1PCS)      鼓架右侧臂 (1PCS)      军鼓支撑架 (1PCS)

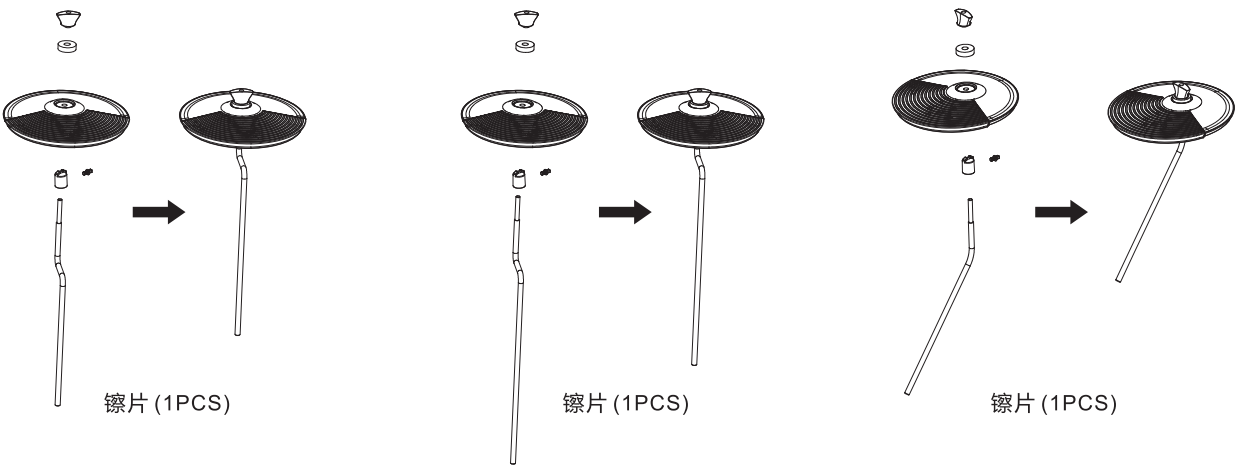

镲片 (1PCS)      镲片 (1PCS)      镲片 (1PCS)

总装示意图

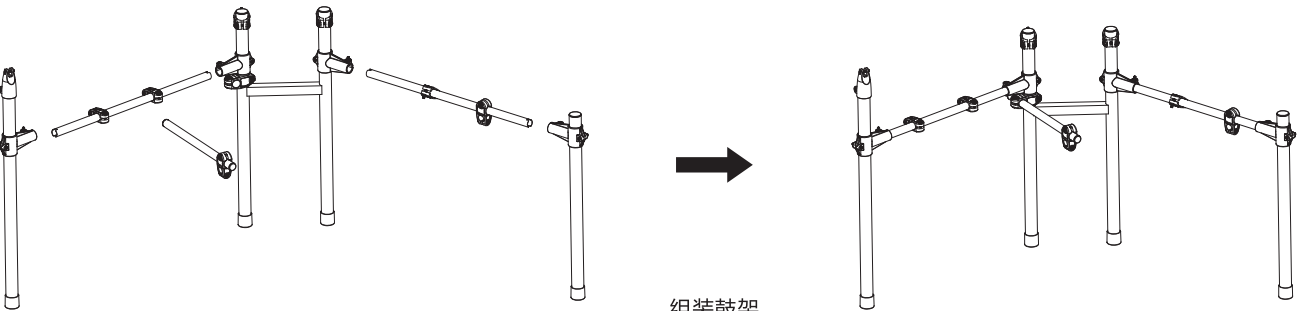

组装鼓架

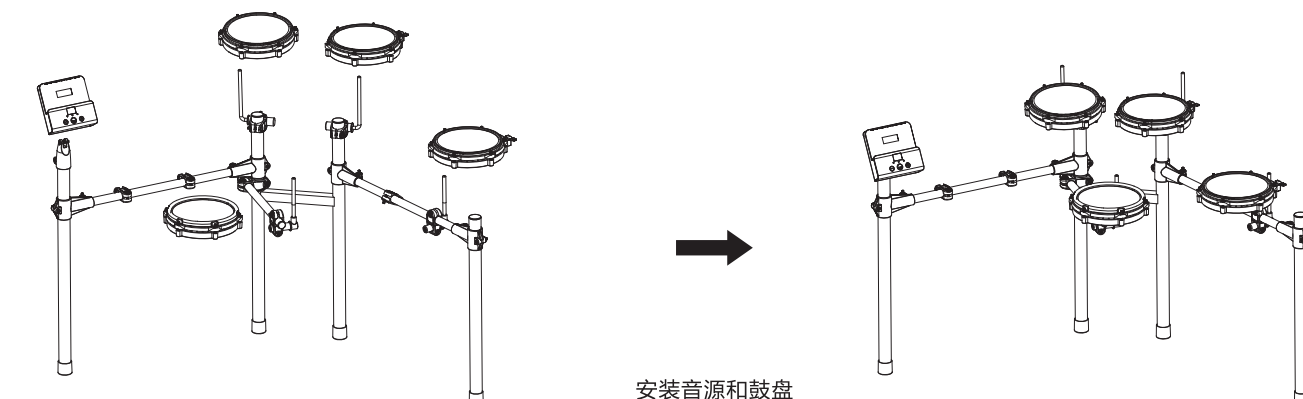

安装音源和鼓盘

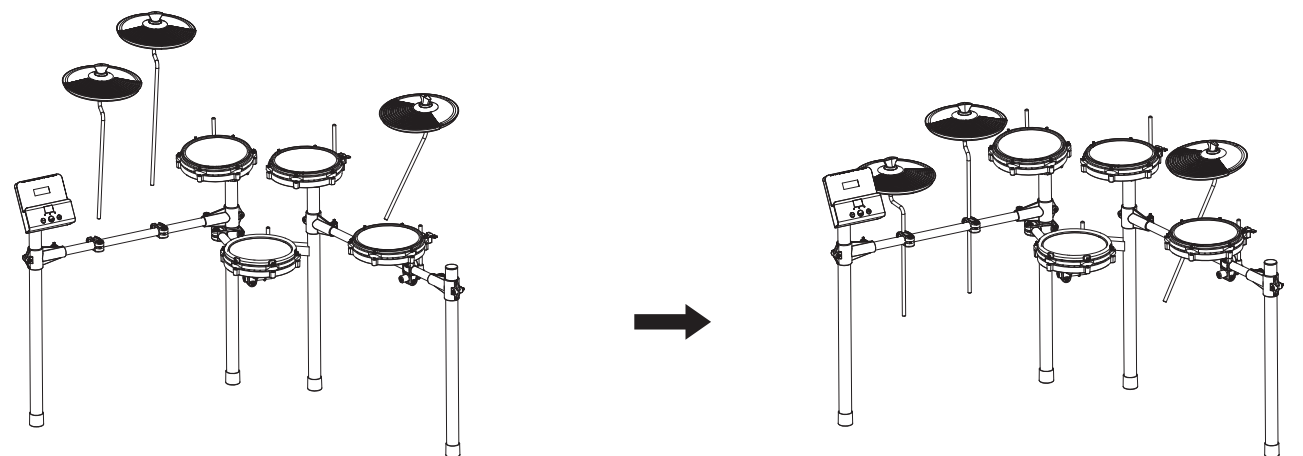

安装镲片

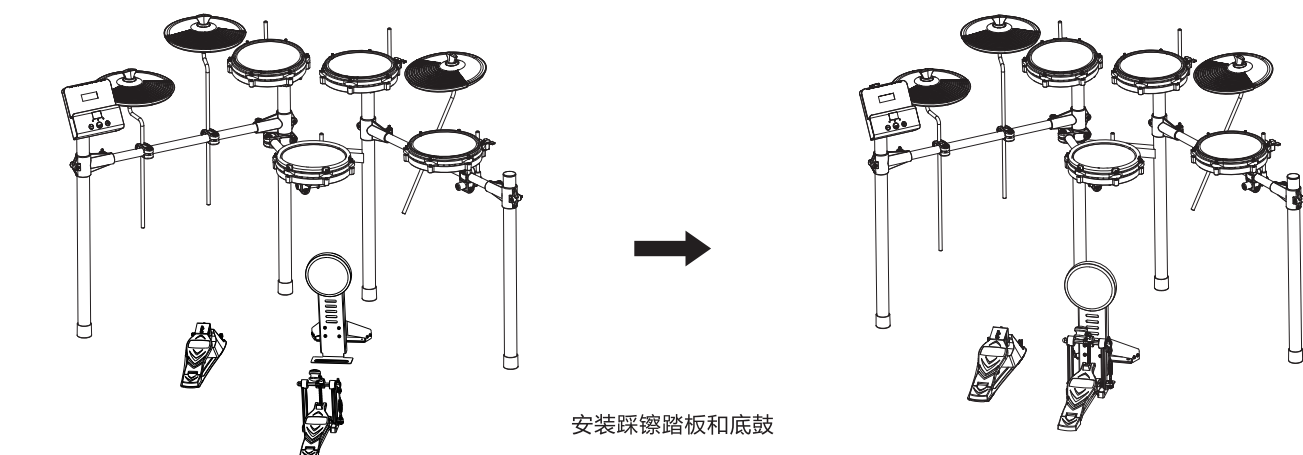

安装踩镲踏板和底鼓

连接数据线

1. 连接数据线到音源系统。

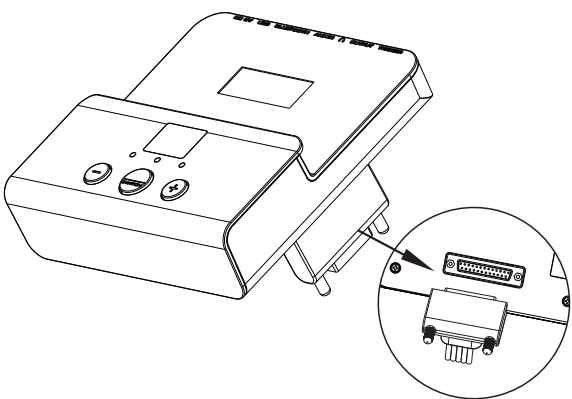

2. 连接鼓盘和镲片。

连接线上的标签指示所连接的打击垫或踏板的名称。

如下图所示：

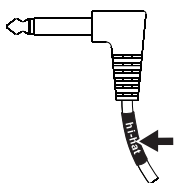

连接鼓盘：

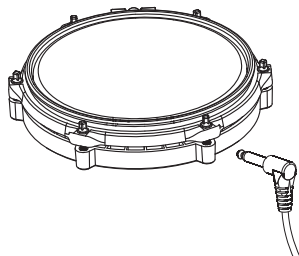

连接镲片：

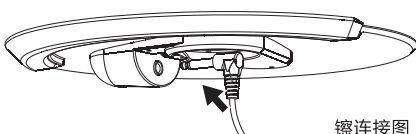

镲连接图

3. 连接踩镲踏板和底鼓踏板。

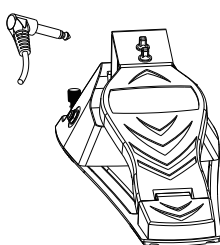

连接踏板

**注意：** 为了防止设备故障或损坏，在连接设备时，请调低音量并把设备电源关闭。

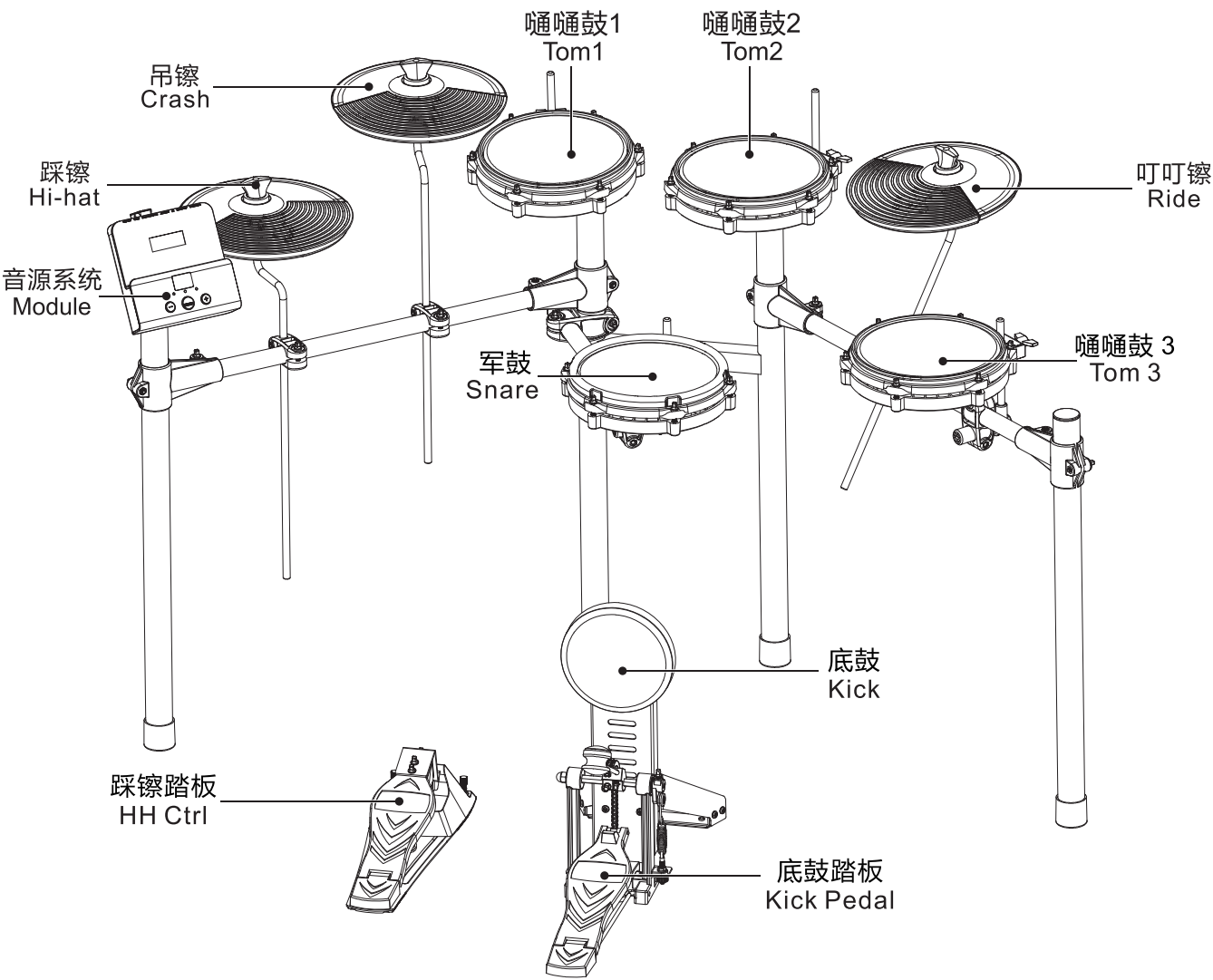

- 1.显示屏
- 2.参数选择与调节按键
- 3.开关/确认按键
- 4.参数选择与调节按键

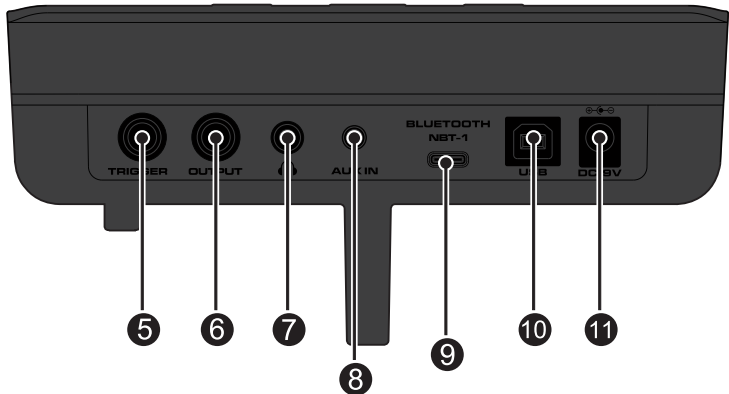

- 5.TRIGGER拓展接口
- 6.OUTPUT接口(单声道)
- 7.耳机接口
- 8.AUX IN音频接口
- 9.蓝牙模块接口
- 10.USB接口
- 11.DC-9V电源接口

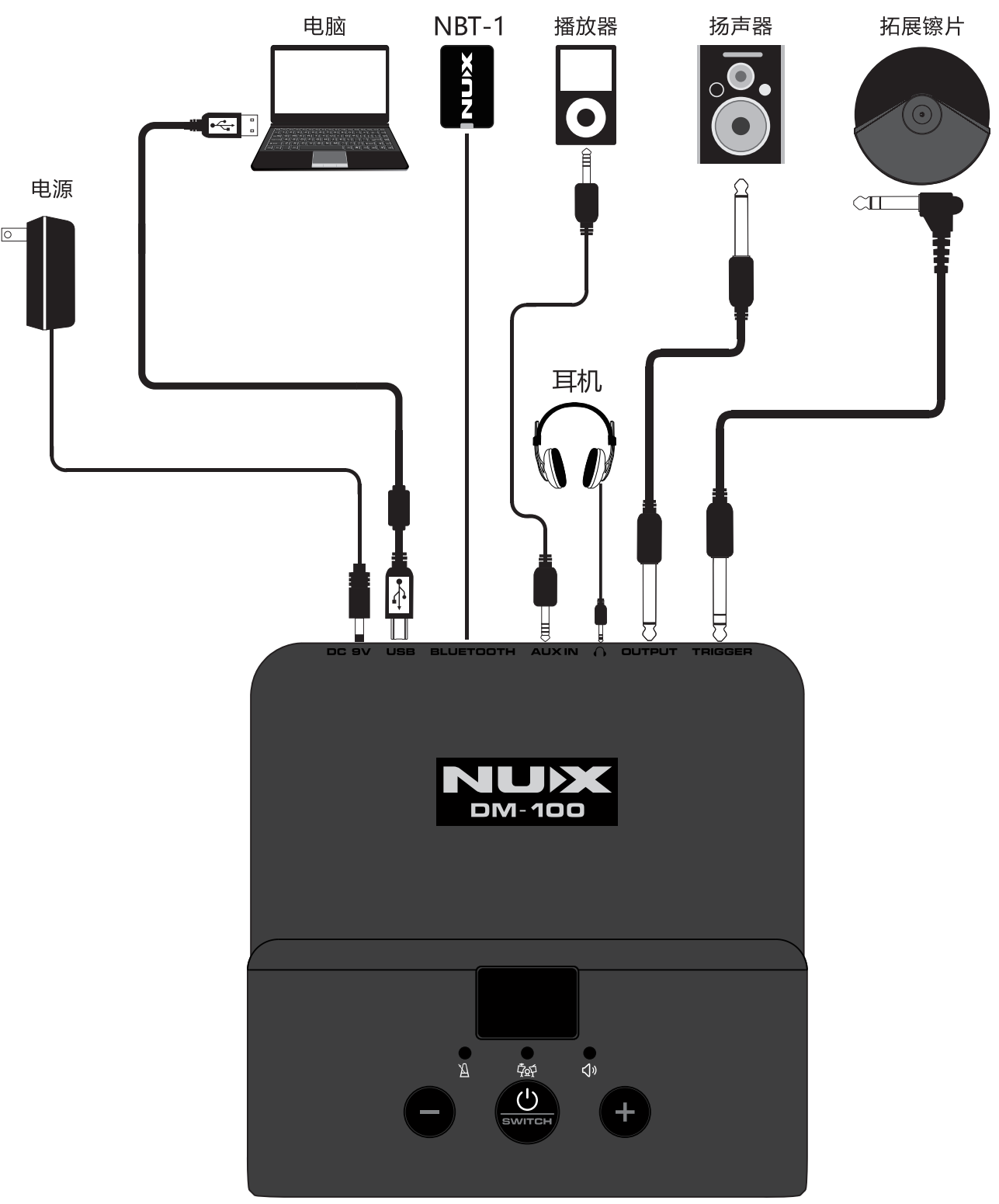

**注意：**  
为了防止本乐器故障或损坏，在开机或进行其它设备连接前，请调低音量并把设备电源关闭。

**\*开启电源**

1. 将外扩设备音量调节至最小。
2. 打开电源。



**注：**打开电源时，可能会听到微弱的声响，这是正常现象，并非故障。

3. 敲击鼓盘、镲片，调节音量。  
按照你的需要提高外扩设备的音量。

**\*关闭电源**

1. 将DM-100外扩设备的音量调节至最小。
2. 关闭外扩设备的电源。
3. 关闭DM-100的电源。



\*军鼓 ( Snare )

**面击**  
打击鼓面

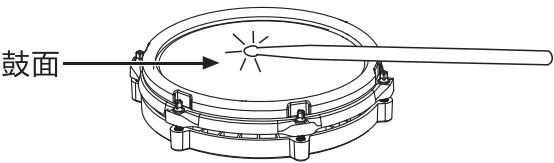

**边击**  
打击鼓边

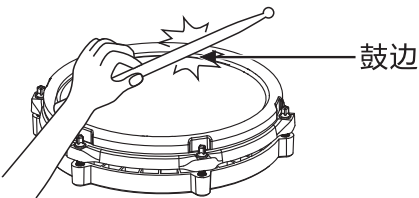

\* 嗵鼓 ( Tom )

**面击**  
打击鼓面

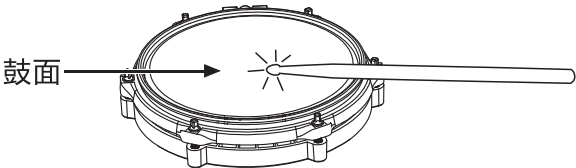

\*底鼓 ( Kick )

打击 踩下底鼓踏板

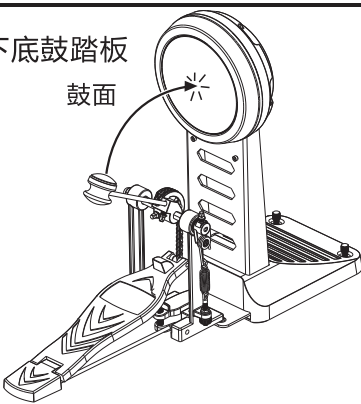

\* 镲片 ( Crash Ride )

**面击**  
打击镲片的面

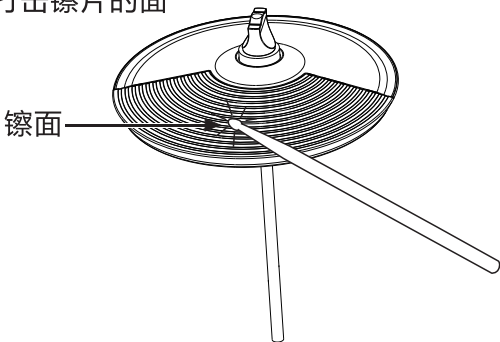

**边击**  
打击镲片的边缘

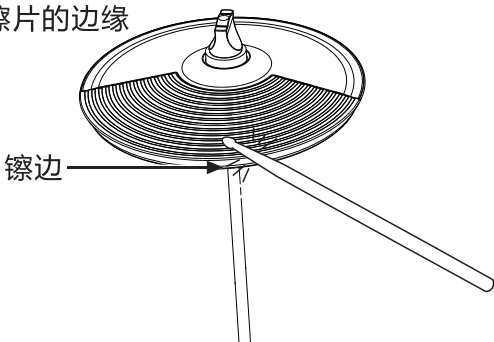

**镲片静音**  
打击镲片后，立即用手捏住镲片的边缘将会进行静音。如图所示捏住边缘触发器的位置。如果您捏住其它无触发器的位置，镲片将不会静音。

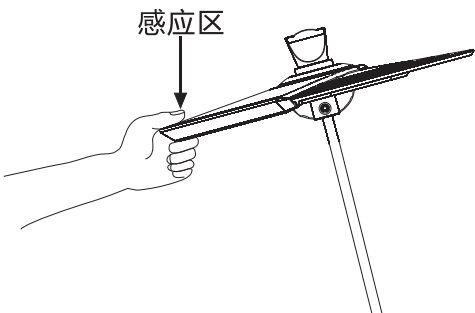

\*踩镲 ( Hi-hat )

**开放/闭合**  
踩镲音色将在开放和闭合之间改变，这将取决于踩镲踏板的力度控制。

**面击**  
打击镲片的面

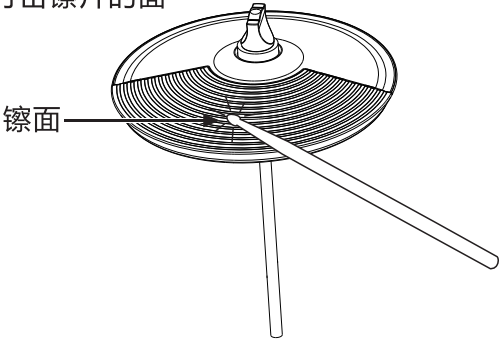

**镲片静音**  
打击镲片后，立即用手捏住镲片的边缘将会进行静音。如图所示捏住边缘触发器的位置。如果您捏住其它无触发器的位置，镲片将不会静音。

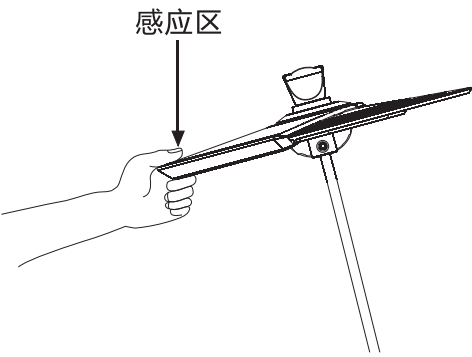

\*踩镲控制踏板 ( HH Ctrl )

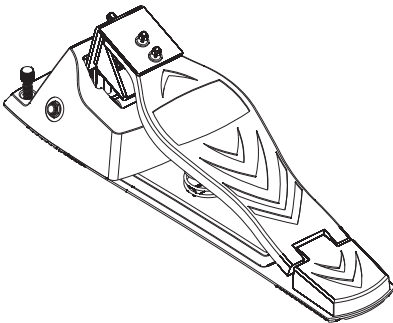

**开放踩镲**  
不踏下踏板，打击踩镲。

**闭合踩镲**  
踏下踏板，打击踩镲。



\*音源器面板操作

套鼓整体切换

- 1. 短按开关/SWITCH按钮，切换到鼓组模式， 指示灯亮起。
- 2. 使用- +按键选择鼓组。

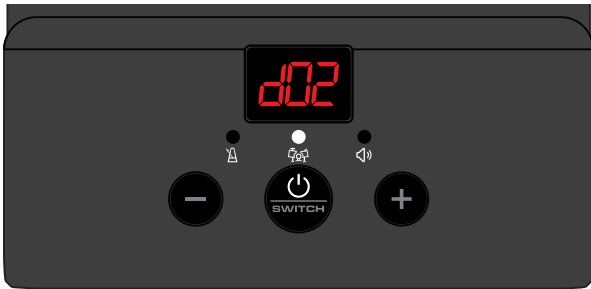

节拍器速度调节

- 1. 短按开关/SWITCH按钮，切换到节拍器模式， 指示灯亮起。
- 2. 使用- +按键调节节拍器速度。
- 3. 再次短按开关/SWITCH按钮关闭节拍器。

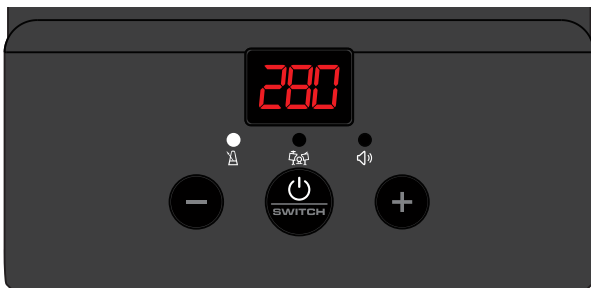

音量调节

- 1. 短按开关/SWITCH按钮，切换到音量调节， 指示灯珠亮起。
- 2. 使用- +按键调节音量大小。

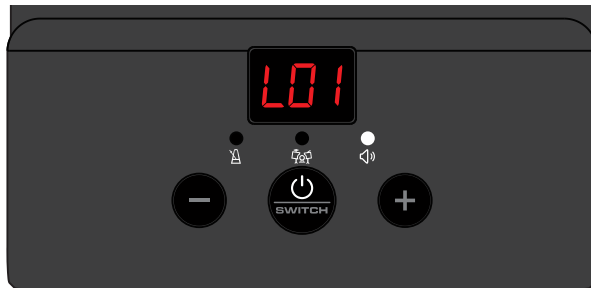

\*APP(Drum Touch)功能操作

当您下载并安装好APP后，连接您的电鼓到手机/平板，打开软件，此时您可以通过控制台对您的电鼓进行控制。



请扫码下载DM-100控制器。

\*如需了解Drum Touch操作方法及功能参数，请查看官网《Drum Touch操作指南》

\*AUX IN 返录功能

- 1. 通过AUX IN接口连接手机/iPad 至DM-100主机。
  - 2. 打开手机/iPad上自带录音APP，点击手机上的录音键后开始演奏，演奏的内容将会被录至手机/iPad中。
- \*需要使用返录功能时，请使用三环四段式的3.5mm音频连接线。

\*恢复出厂设置

- 1. 在关机状态下同时按住 和 按键，屏幕显示FFF，此时音源器恢复出厂设置。

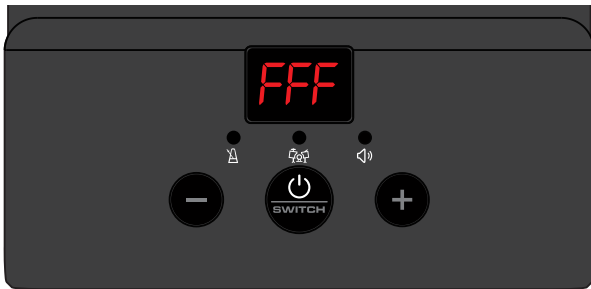

Function		Transmitted	Recognized	Remarked
Basic default		10	10	
Channel changed		Yes	Yes	
Note		0-127	0-127	
Velocity:	Note on	Yes	Yes	
	Note off	Yes	Yes	
After Key's		No	Yes	
Touch Channel's		No	Yes	
Control change:	0	No	Yes	Bank select
	1	No	Yes	Modulation
	5	No	Yes	Portamento time
	7	No	Yes	Volume
	10	No	Yes	Pan
	11	No	Yes	Expression
	64	No	Yes	Sustain pedal
	65	No	Yes	Portamento on/off
	66	No	Yes	Sostenuto pedal
	67	No	Yes	Soft pedal
	120	No	Yes	All sound off
	121	No	Yes	Reset all controllers
	123	No	Yes	All note off
Program change		No	Yes	
System exclusive		No	Yes	

技术规格

显示: 三位数码管  
鼓组: 12套预设鼓组、3套用户鼓组  
USB功能: USB MIDI、USB audio  
效果器类型: 全局EQ、混响效果  
触发器: 8寸军鼓x 1、8寸嗵鼓x 3、10寸镲片x3、6寸底鼓x1、踩镲踏板x 1  
接口: 电源接口、6.35mm单声道输出接口、AUX IN接口、USB接口、拓展接口、耳机接口、蓝牙模块接口  
电源: DC9V外正内负、工作电流≤200mA

\*技术规格如有变更，恕不另行通知。

有关产品中所含有害物质限量的说明

为了控制和减少电器电子产品废弃后对环境造成的污染，本资料就本公司产品中所含的特定有害物质限量及其安全性予以说明。

本资料适用于2022年12月31号以后本公司所制造的产品。

环保使用期限



此标志适用于在中国国内销售的电子信息产品，表示环保使用期限的年数。所谓环保使用期限是指在制造日起的规定期限内，产品中所含的有害物质不致引起环境污染，不会对人身、财产造成严重的不良影响。环保使用期限仅在遵照产品使用说明，正确使用产品的条件下才有效。不当的使用，将会导致有害物质泄漏的危险。

产品中所含有害物质限量说明

项目	限量	
邻苯二甲酸酯类物质的限量	A类	B类
	○	○
多环芳烃类物质的限量	A类	B类
	○	○
可迁移元素物质的限量	A类	B类
	○	○
苯系物、总挥发有机化合物及甲醛物质的限量	○	
五氯苯酚（PCP）物质的限量	○	
电子部件限用物质的限量	○	
天然放射性核素的限量	○	

\*上表当中的信息依据GB 28489-2022仅在产品含有其中限量要求项目时适用。

本表格依据GB 28489-2022的规定编制。  
○表示该有害物质在该部件所有均质材料中的含量均在GB 28489-2022第五章规定的限量要求以下。

**保护环境**  
如果需要废弃本产品，请遵循本地相关指引，请勿随意丢弃或作为生活垃圾处理，以避免对环境造成污染。

质量承诺

亲爱的 **NUX** 用户：

在您使用 **NUX** 产品时，请仔细阅读产品说明书，当您有疑问和困难时，请拨打售后服务热线：

**400-990-9866**

■ 一周内出现质量问题可退货退款

■ 一月内出现质量问题可调换

■ 一年内出现质量问题可免费维修

■ 终身享有咨询和维修服务

[ 请向销售商索取正规发票并予以保存 ]

换修政策

- 一、包换政策：
- 1、消费者通过正规授权渠道购买的产品，自购机之日起1个月之内，在正常使用情况下出现非人为的产品性能故障、且产品外观及包装保持完好，可向所购机的经销商换机。
  - 2、消费者在换机时应出示由经销商开出的购机凭证，否则经销商可以不予更换。
- 二、保修政策：
- 1、消费者通过正规授权渠道购买的产品(以发票所示销售方为准)，自购买之日起1年内，若出现非人为损坏的性能故障，可享受免费维修服务。
  - 2、对于超过1年或人为及不可抗力因素造成损坏的产品， 我司可提供有偿维修服务。

\*本售后政策仅适用于中国大陆地区，其它国家及地区以当地售后政策及法律法规为准。

售后服务地址

广东省珠海市高新区唐家湾镇科技九路10号 邮编:519080  
珠海市蔚科科技开发有限公司 售后服务部  
制造商: 珠海市蔚科科技开发有限公司 生产商: 珠海市蔚科科技开发有限公司  
地址: 珠海市高新区唐家湾镇科技九路10号  
电话: 0756-3689 866 网址: cn.nuxaudio.com

合格证

名 称：电子鼓

检验员：型 号：DM-100 DM-110

生产日期：本产品经检验合格  
执行标准: Q/WKDZ 003-2020